

CLUBtalk

WHAT IS CLUBTALK?	113
PLANNING WITH CLUBTALK	114
CLUBTALK TYPICALS	116
MOBILE CART OVERVIEW	125
MOBILE CART BASICS	126
PLANNING WITH THE TEK BOX	128
SPECIFYING THE MOBILE CART	129
TABLES BASICS	130
PLANNING WITH TABLES	131
WORKSURFACE MONITOR MOUNT COMPONENT OVERVIEW	132
WORKSURFACE MONITOR MOUNT BASICS	133
PLANNING WITH WORKSURFACE MONITOR MOUNT	134
13" MODULAR TABLE BASICS	136
HOW CLUBCONNECT WORKS	137
CLUBCONNECT BASICS	140
SPECIFYING CLUBCONNECT	141
CLUBTALK FINISHES	142
GRAIN DIRECTION	144

what is CLUBtalk?

CLUBtalk provides planning solutions that integrate furniture and technology to make collaboration more effective.



113

inspiration

In today's workplace, employees need to easily engage, interact and share ideas. The pervasive and varied use of mobile technology impacts the way people access and share information.

Designed in collaboration with Carl Gustav Magnusson, CLUBtalk expresses and supports the dynamic nature of the contemporary office and the active work styles of a technology-enabled workforce no longer tethered to a desk or an office.

In the words of the designer, "CLUBtalk is latent with energy. Action is implied in the design, which is visually energizing to the point of curiosity and very engaging once one understands what this tool can do for them."

Like precision-engineered performance equipment of all types, CLUBtalk is exact, intentional and distinctive, yet has a universal quality appropriate for a variety of environments.

CLUBtalk signals a unique destination, a place to "share real-time information and hasten the intellectual process."

key features

- **Compact** – all the functionality of a conference room in a stand-alone unit
- **Mobile** – casters allow for relocation throughout the office
- **Flexible** – ability to communicate in-house and remotely (conferencing)
- **Fast & Simple** – a way to share information across multiple platforms with multiple users
- **Height Adjustable** – to accommodate comfort during collaboration from Lounge or Task and Counter or Bar heights
- **Adaptable** – to multiple environments (formal meeting rooms, team spaces and casual lounge areas)
- **Versatile** – can be used with multiple types of devices (smartphones, tablets, laptops)
- **Integrates** – with other Teknion furniture and systems

planning with CLUBtalk

CLUBtalk is available in a variety of formats to provide a means of sharing information among users.

components

CLUBtalk consists of a simple product map that allows for a variety of configurations:

- Mobile Cart (with or without a Tek Box): is available in Lounge or Task and Counter or Bar heights
- Worksurface Monitor Mount
- CLUBconnect
- Tables: Square, Trapezoid and Rectangular

CLUBtalk is also available in the dna Collection, please see the Seating User & Price Guide for more details.

mobile cart

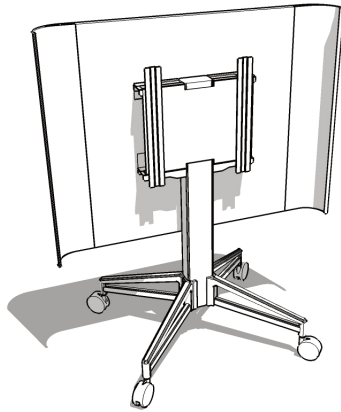

without Tek Box

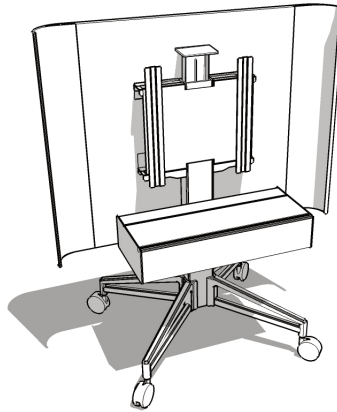

with Tek Box

worksurface monitor mount

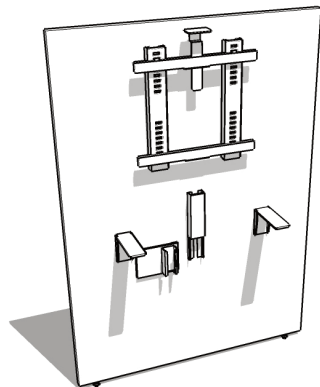

without Tek Shelf

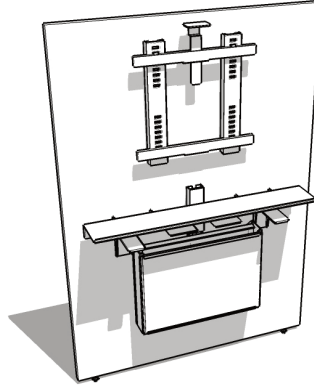

Tek Shelf with
CLUBconnect Support

planning with CLUBtalk (continued)

tables

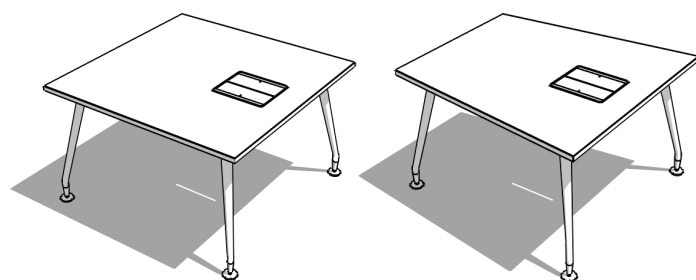

Square Table (CUS)

Trapezoid Table (CUZ)

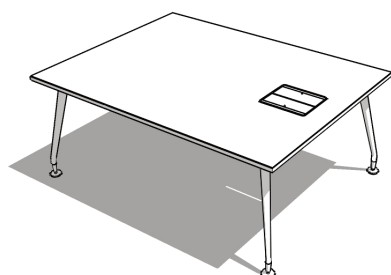

Rectangular Table (CUR)

CLUBconnect



Four Sensors

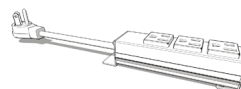

Power Receptacle

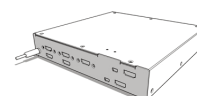

Switcher

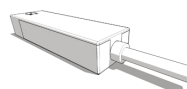

Wireless Transmitter
(optional)

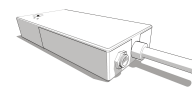

Wireless Receiver
(optional)

dna

The CLUBtalk 13" Modular Table integrates with the dna table and seating, please see the Seating User & Price Guide for more details.

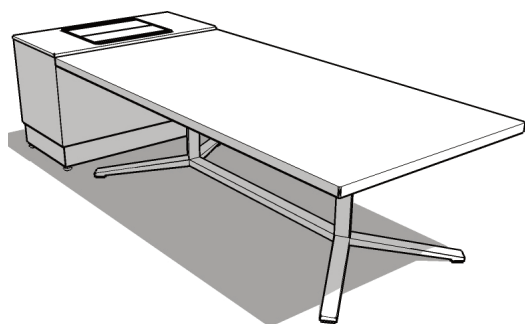

13" Modular Table (CUFM)
shown with dna - Rectangular
Freestanding Coffee Table (NDNU)

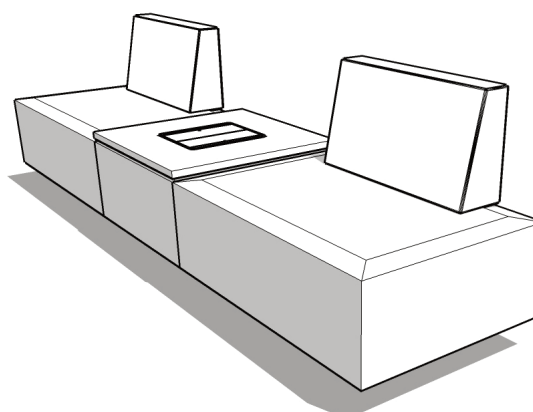

dna Square Table with CLUBtalk
Technology (NDNS)
shown with dna - Modular Seating
Bench (NDN)

CLUBtalk typicals

The following typicals demonstrate the planning capabilities for CLUBtalk.

CLUBtalk can be used in meeting rooms, informal meeting spaces in the open plan and at workstation clusters in a benching application. It can be used for large meetings with teams for brainstorming ideas, interactive teamwork or group presentations. The participants can be employees in house or a combination of in-house and remote staff. It can also be used for smaller scale meetings where information may only be shared by one person to a group.

small meeting, CLUBtalk mobile cart, lounge or task height

- Task height
- CLUBtalk Mobile Cart without Tek Box and CLUBtalk table with CLUBconnect technology

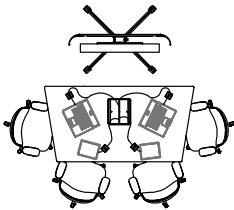

Small Mobile Cart (CUC) and CLUBconnect (CUT)
Task height 29"

Trapezoid Table (CUZ)
48" deep x 72" width A x 60" width B

CLUBtalk Tables are complete with an Access Door Module to hold CLUBconnect technology (power receptacle, Switcher and Sensors, optional wireless transmitter and receiver).

QUANTITY	COMPONENTS	DESCRIPTION	LIST PRICE	EXTENDED PRICE
1	CUCA0S	CLUBtalk Mobile Cart, Lounge or Task height, No Tek Box, Small Monitor (40" - 46")	3312	3312
1	CUZS4872	CLUBtalk Trapezoid Table, 48" Deep x 72" Wide	3278	3278
1	CUT4N	CLUBconnect, four sensors, with wireless transmitter and receiver	16300	16300
TOTAL				22890

CLUBtalk Mobile Cart, Lounge or Task height, Flintwood, Clear Anodized, Painted Platinum & Graphic Steel
CLUBtalk Trapezoid Table finishes: Flintwood & Mica

Also shown above:

QUANTITY	COMPONENTS	DESCRIPTION
4	NPRTNW	Projek Synchro-Tilt, Dual Upholstery, No Headrest, 2D Width & Height Adjustable T-Arms

CLUBtalk typicals (continued)

small meeting room, CLUBtalk mobile cart, lounge or task height

- Task height
- CLUBtalk Mobile Cart without Tek Box and CLUBtalk table with CLUBconnect technology

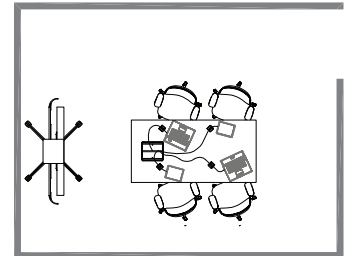

One Small Mobile Cart (CUC) and CLUBconnect (CUT)

Task height 29"

15' x 12' meeting room

Rectangular Table (CUR)

54" deep x 72" wide rectangular meeting table

II7

When a more flexible option is desired, CLUBconnect allows for a wireless application. In this option, the Mobile Cart does not need to be connected to the table or worksurface, freeing up space between the cart and the table or worksurface.

The wireless transmitter is located under the table or worksurface while the receiver is mounted on the Mobile Cart (behind the monitor) with a bracket which is included. Please note that the monitor and receiver still require a hard wired power source.

A wireless transmitter and receiver are provided when the wireless option is selected.

Identifiers are available for easy identification for each unit in a mobile environment.

QUANTITY	COMPONENTS	DESCRIPTION	LIST PRICE	EXTENDED PRICE
1	CUCA0S	CLUBtalk Mobile Cart, Lounge or Task height, No Tek Box, Small Monitor (40" - 46"), with Identifier	3390	3390
1	CURS5472	CLUBtalk Rectangular Table, 54" Deep x 72" Wide, with Mica	3371	3371
1	CUT4Y	CLUBconnect, four sensors, with wireless transmitter and receiver	16300	16300
TOTAL				23061

CLUBtalk Mobile Cart, Lounge or Task height, Flintwood, Clear Anodized, Painted Platinum & Graphic Steel

CLUBtalk Rectangular Table finishes: Flintwood & Mica

Also shown above:

QUANTITY	COMPONENTS	DESCRIPTION
4	NCSY1HD	Contessa Executive Chair, Dual Upholstery, 2D Arms; Height and Pivot

Optos Walls shown above are available from Teknion's Architectural Walls Price and Product Guide.

CLUBtalk typicals (continued)

meeting room, CLUBtalk mobile cart, counter or bar height

- Counter height
- CLUBtalk Mobile Cart complete with Tek Box and CLUBconnect technology

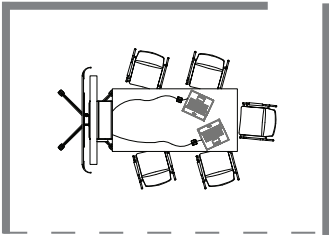
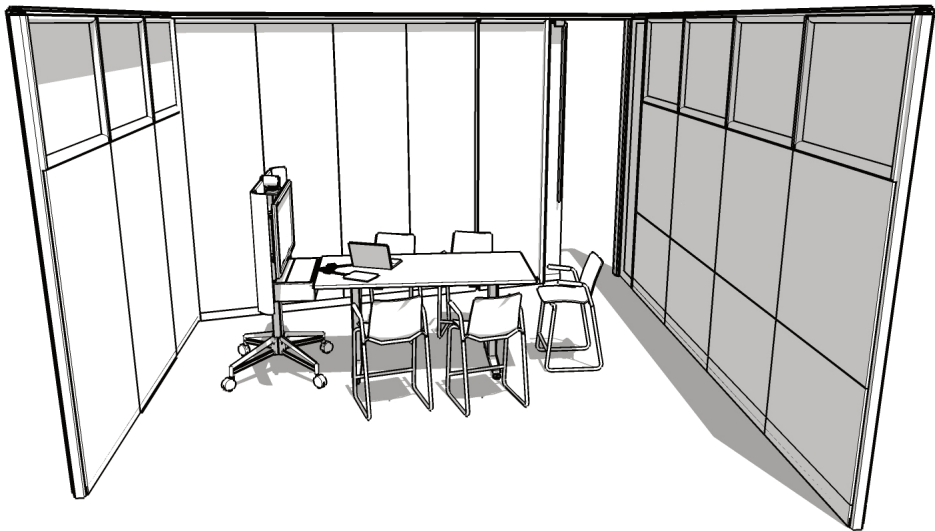

One Small Mobile Cart (CUC) and CLUBconnect (CUT)
Counter height 36"
15' x 10' meeting room
Livello Meeting Table (LVMR)
36" deep x 72" wide rectangular meeting table

118

Mobile Carts with a small surround offer two additional heights; Counter (36" high, shown) or Bar height (42" high). These heights allow for various ways of working in many wired or wireless environments.

QUANTITY	COMPONENTS	DESCRIPTION	LIST PRICE	EXTENDED PRICE
1	CUCB2S	CLUBtalk Mobile Cart, Counter or Bar height, Tek Box with CLUBconnect Support, Small Monitor (40" - 46")	4347	4347
1	CUT4N	CLUBconnect, four sensors, without wireless transmitter and receiver	14890	14890
TOTAL				19237

CLUBtalk Mobile Cart, Counter or Bar height, Tek Box with CLUBconnect Support finishes: Flintwood, Clear Anodized, Painted Platinum & Graphic Steel

Also shown above:

QUANTITY	COMPONENTS	DESCRIPTION
1	LVMR7F36072	Livello Rectangular Meeting Table, Standard Range, 36" Deep x 72" Wide
5	NNASCK	Nami Guest Counter Stool, Sled Frame, Integrated Arms

Altos Walls shown above are available from Teknion's Architectural Walls Price and Product Guide.

CLUBtalk typicals (continued)

open plan, CLUBtalk mobile cart, counter or bar height

- Bar height
- CLUBtalk Cart complete with CLUBconnect technology

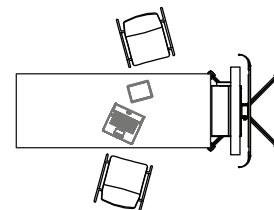

Small Mobile Cart (CUC) and CLUBconnect (CUT)

Bar height 42"

36" deep x 84" wide worksurface supported by two 42" high x 16" deep x 36" wide bookcases and a 42" high post leg

Planning at Bar height can be used for smaller collaborative environments. Standing height provides worksurfaces for perching and quick meetings.

QUANTITY	COMPONENTS	DESCRIPTION	LIST PRICE	EXTENDED PRICE
1	CUCB2S	CLUBtalk Mobile Cart, Counter or Bar height, Tek Box with CLUBconnect Support, Small Monitor (40" - 46")	4347	4347
1	CUT4N	CLUBconnect, four sensors, without wireless transmitter and receiver	14890	14890
TOTAL				19237

CLUBtalk Mobile Cart, Counter or Bar height, Tek Box with CLUBconnect Support, finishes: Flintwood, Clear Anodized, Painted Platinum & Graphic Steel

Also shown above:

QUANTITY	COMPONENTS	DESCRIPTION
1	UNWR3684	Rectangular Worksurface, 36" Deep x 84" Wide
1	ATCSC	Square Cafe Table, Mono-Pod Base, 42" High (base only)
2	UBKS4236	Standard Bookcase, 42" High x 16" Deep x 36" Wide
2	NNAHCN	Nami Guest Bar Stool, Sled Frame, No Arms (1 shown)

CLUBtalk typicals (continued)

workstation clusters, CLUBtalk mobile cart, lounge or task height

- Task height
- CLUBtalk Mobile Cart complete with Tek Box and CLUBconnect technology

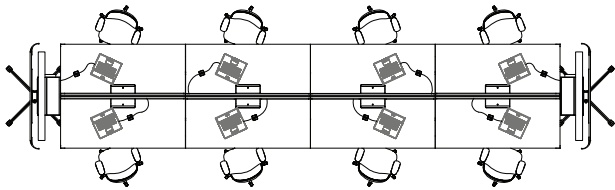

Two Small Mobile Carts (CUC) and CLUBconnect (CUT)

- Task height 29"
- Eight Interpret workstations, 30" x 72" (overall 5' x 24')

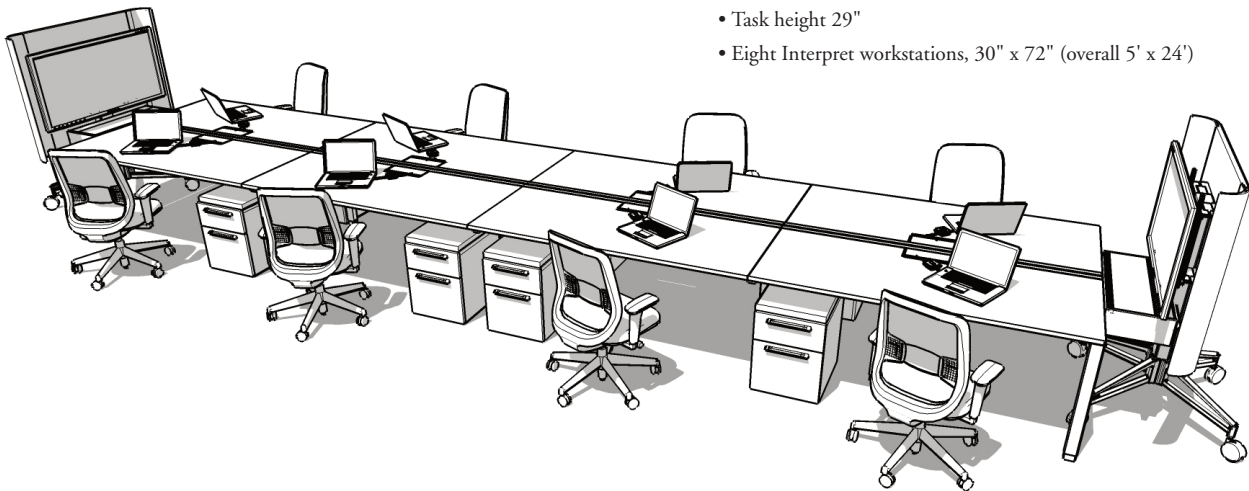

The Mobile Cart is used with CLUBconnect. Supports and Sensors which allows for collaboration amongst teams without the need for formal meeting rooms or enclosed spaces.

QUANTITY	COMPONENTS	DESCRIPTION	LIST PRICE	EXTENDED PRICE
2	CUCA2S	CLUBtalk Mobile Cart, Lounge or Task height, Tek Box with CLUBconnect Support, Small Monitor (40" - 46")	4140	8280
1	CUT4N	CLUBconnect, four sensors, without wireless transmitter and receiver	14890	14890
TOTAL				23170

CLUBtalk Mobile Cart finishes: Flintwood, Clear Anodized & Painted Platinum

Also shown above:

QUANTITY	COMPONENTS	DESCRIPTION
1	WWSDBASSR286	Double Sided Beginning Frame, with Accessory Beam, Straight End Legs, Straight Recessed Intern 28" High x 60" Deep x 72" Wide
2	WWSDMASR2860	Double Sided Middle Frame, with Accessory Beam, Straight Recessed Legs, 28" High x 60" Deep x 72" Wide
1	WWSDFAS28607	Double Sided Finish Frame, with Accessory Beam, Straight Legs, 28" High x 60" Deep x 72" Wide
8	WWWRPD3072	Power Cut-Out Worksurface, for Double Sided Frame, 30" Deep x 72" Wide
8	WWEDR	Power Access Door
2	WWEBF8T072	Base Feed, 8 Wire Isolated Ground, 72" Long
2	WWEBC	Base Feed Cover
4	WWEPMd	Power Module for Double Sided
16	WWErOS	Receptacle Outlet, Standard 15 Amp
2	WWEPH8T72	Power Harness, 8 Wire Isolated Ground, 72" Long
8	WWEPTDY72	Power Tray, Double Sided, Two Duplex Cut-Outs, 72" Wide
8	UPRRX19	Rolling Pedestal, Box/File, 19" Deep
8	NPRTNW	Projek Synchro-Tilt, Dual Upholstery, No Headrest, 2D Width & Height Adjustable T-Arms

CLUBtalk typicals (continued)

informal meeting spaces, CLUBtalk lounge or task height

- Lounge height
- CLUBtalk Mobile Cart with Tek Box

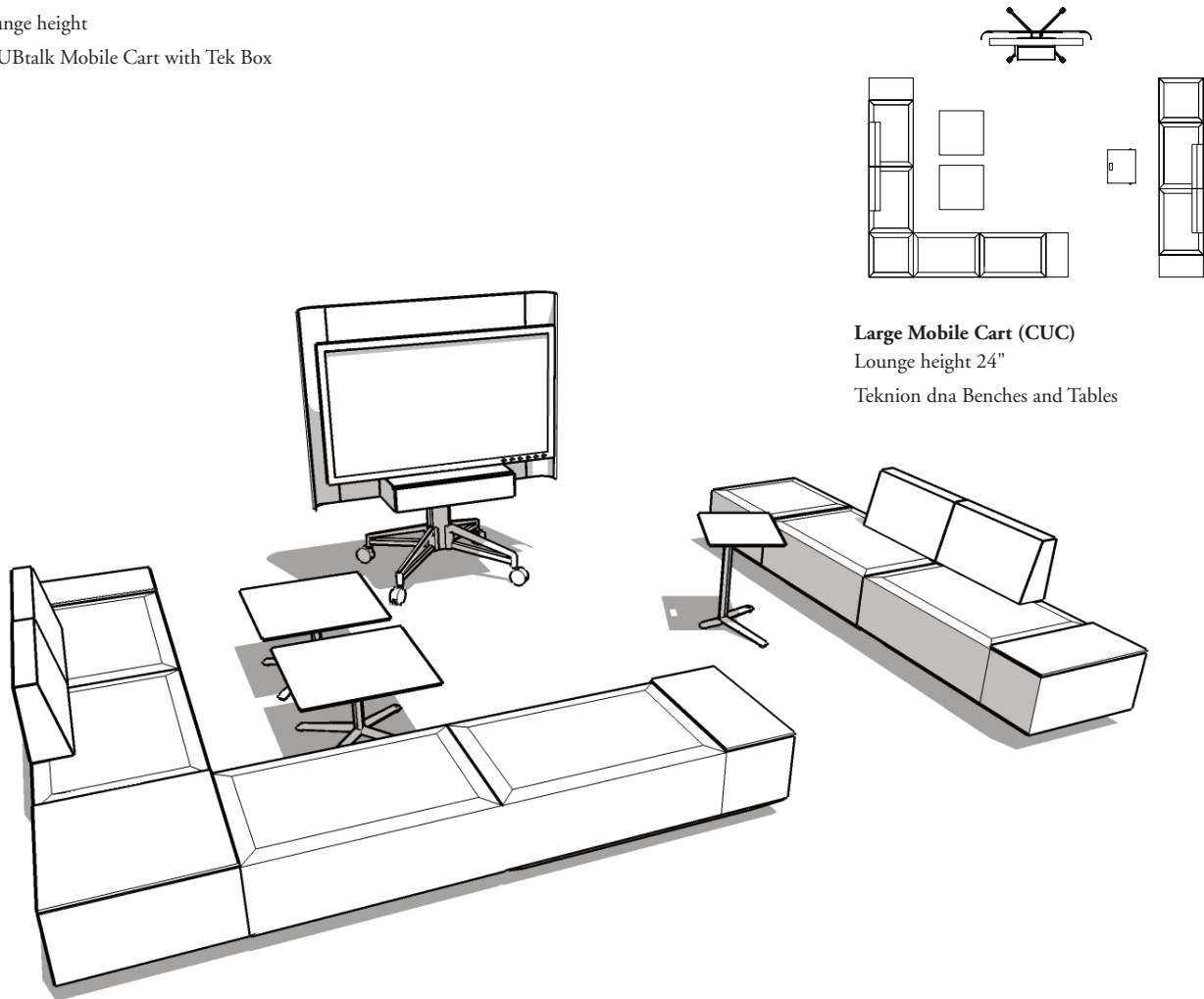

Large Mobile Cart (CUC)
Lounge height 24"
Teknion dna Benches and Tables

CLUBtalk is used in its most simple form, as a surround with a monitor to connect to and view media. An empty Tek Box provides access to four receptacles and can be used to house remote controls and various devices.

QUANTITY	COMPONENTS	DESCRIPTION	LIST PRICE	EXTENDED PRICE
1	CUCA1L	CLUBtalk Mobile Cart, Lounge or Task height, with Tek Box, Large Monitor (56" - 60")	3985	3985
TOTAL				3985

CLUBtalk Mobile Cart finishes: Flintwood, Clear Anodized & Painted Platinum

Also shown above:

QUANTITY	COMPONENTS	DESCRIPTION
1	NDNAN	dna Modular Seating - Bench, No Side Table
1	NDNAT	dna Modular Seating - Bench, With Side Table
2	NDNBND	dna Modular Seating - Bench With Bolster, No Table, Dual Upholstery
2	NDNBTRD	dna Modular Seating - Bench With Bolster, Right Table, Dual Upholstery
1	NDNCN	dna Modular Seating - Square Seat, No Table
1	NDNS	dna Modular Square Table
2	NDNTS	dna Freestanding Coffee Table, Square
1	NDNL	dna Freestanding Laptop Table

CLUBtalk typicals (continued)

meeting area, worksurface monitor mount, task height, interpret table, grommet

- Task height
- Worksurface Monitor Mount without Tek Shelf

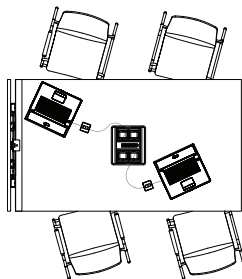

Worksurface Monitor Mount (CUWM)
Task height 29"

Interpret Meeting Table with CLUBtalk
Table, Grommet (WWTMT)
42" wide x 72" long

The Worksurface Monitor Mount with no Shelf mounts to Interpret tables with CLUBtalk technology to provide a wireless connection.

QUANTITY	COMPONENTS	DESCRIPTION	LIST PRICE	EXTENDED PRICE
1	CUWM	Worksurface Monitor Mount, 42" Wide x 60" High	1289	1289
1	WWTMT	Interpret Meeting Table with CLUBtalk Technology, 48" Wide x 84" Long	3536	3536
1	CUT4N	CLUBconnect, four sensors, with wireless transmitter and receiver	14890	14890
			TOTAL	19715

Worksurface Monitor Mount and Table, finishes: Flintwood, Painted Platinum Trim.

Also shown above:

QUANTITY	COMPONENTS	DESCRIPTION
4	NARTNW	Projek Synchro-Tilt, Dual Upholstered Headrest, 2D Width and Height Adjustable T-Arms

CLUBtalk typicals (continued)

meeting area, worksurface monitor mount, task height, audience table

- Task height
- Worksurface Monitor Mount with Tek Shelf

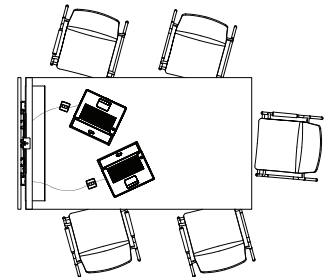

Worksurface Monitor Mount (CUWM)

Task height 29"

Audience Table (ATMR)

42" wide x 72" long

The Worksurface Monitor Mount with Sensor Shelf mounts to the end of a meeting table to allow for easy storage and accessibility of sensors.

QUANTITY	COMPONENTS	DESCRIPTION	LIST PRICE	EXTENDED PRICE
1	CUWM	Worksurface Monitor Mount with Tek Shelf, 42" Wide x 60" High	1651	1651
1	ATMR	Audience Table, 42" Wide x 72" Long	2608	2608
1	CUT4N	CLUBconnect, four sensors, without wireless transmitter and receiver	14890	14890
			TOTAL	19149

Worksurface Monitor Mount and Table, finishes: Flintwood, Painted Platinum Trim.

Also shown above:

QUANTITY	COMPONENTS	DESCRIPTION
4	NARTNW	Projek Synchro-Tilt, Dual Upholstered Headrest, 2D Width and Height Adjustable T-Arms

CLUBtalk typicals (continued)

lounge area, dna coffee table, 13" modular table

- Lounge height
- 13" Modular Table with wireless technology

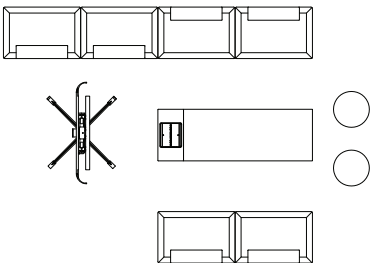

dna Coffee Table (NDNU)
Lounge height 16" high, 26" wide, 60" long

13" Modular Table (CUFM)
Lounge height 16" high

124

The 13" Modular Table is used with the dna Coffee Table to provide a wireless connection in a casual meeting environment.

QUANTITY	COMPONENTS	DESCRIPTION	LIST PRICE	EXTENDED PRICE
1	CUFM	13" Modular Table, Lounge height, 16" High	1195	1195
1	CUC	Mobile Cart no Tekbox, Lounge or Task height	4140	4140
			TOTAL	5335

Worksurface Monitor Mount and Table, finishes: Flintwood, Platinum Trim.

Also shown above:

QUANTITY	COMPONENTS	DESCRIPTION
1	NDNU	dna Coffee Table, 26" Wide x 60" Long x 16 High
6	NDNBND	dna Modular Seating, Bench with Bolster, No Table, Dual Upholstery
2	NCOR	Round Collaborative Ottoman, Small, dna height

mobile cart overview

The following outlines the components and features of the CLUBtalk Mobile Cart.

The Mobile Cart is used in both wired and wireless settings in combination with Teknion's CLUBconnect technology.

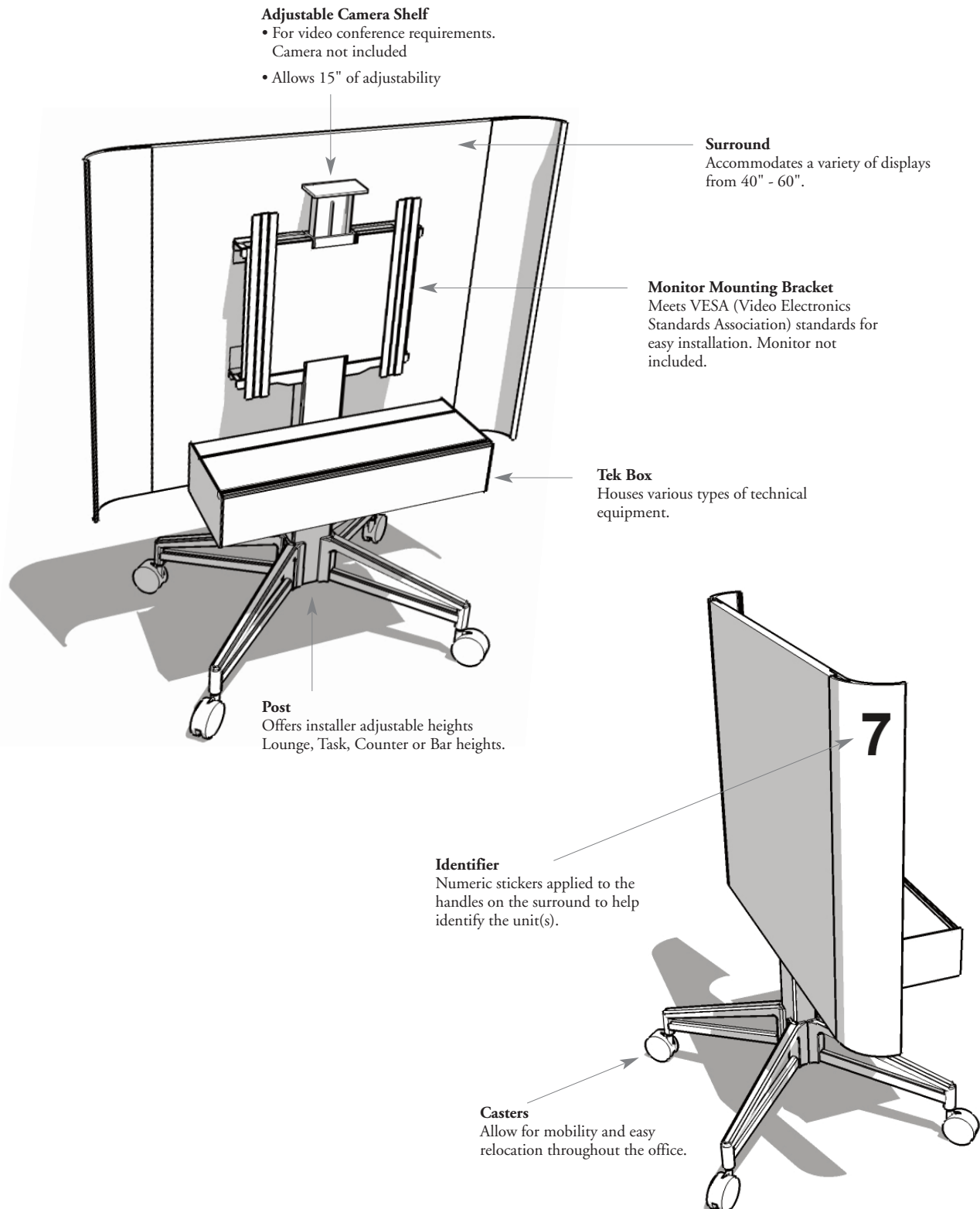

mobile cart basics

The Mobile Cart is used for multiple forms of collaboration and is available in three sizes; small, medium and large.

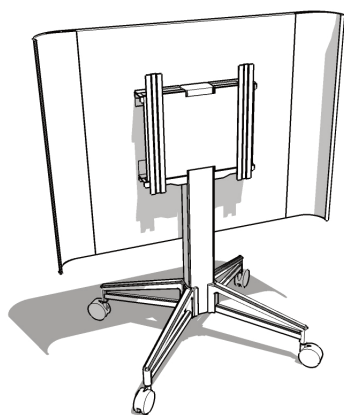

No Tek Box (0)

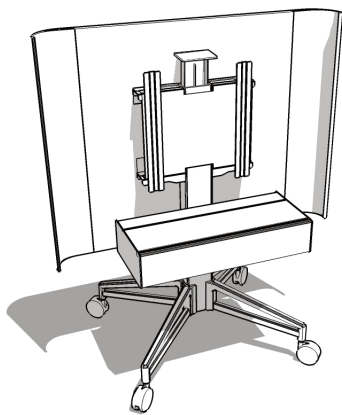

With Tek Box (1, 2, 3)

- Mobile Cart (CUC)**
- The following is the range of monitor sizes that will fit within each surround:
 - Small allows for a monitor size 40" - 46" (S)
 - Medium allows for a monitor size 47" - 55" (M)
 - Large allows for a monitor size 56" - 60" (L)
 - Different adjustable heights are available:
 - Lounge or Task height 24" - 29"
 - Counter or Bar height 36" - 42"
 - Counter or Bar height is only available with the small surround
 - Options include a Tek Box, a camera shelf and identifiers (which are a set of numeric stickers ranging from 0 - 9)
 - The inside surround finish matches the outside finish

monitor heights

The following chart outlines the application heights and monitor sizes available on CLUBtalk.

	Lounge 24" high	Task 29" high	Counter 36" high	Bar 42" high
Small 40" - 46" Monitor				
Medium 47" - 55" Monitor				
Large 56" - 60" Monitor				

mobile cart basics (continued)

The following are the dimensions for the Mobile Cart.

small

Lounge

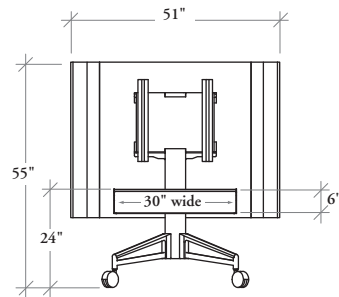

Task

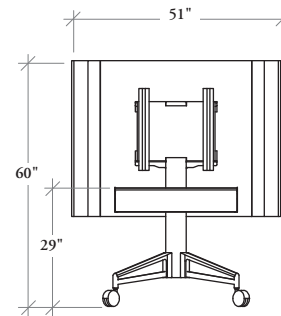

Counter

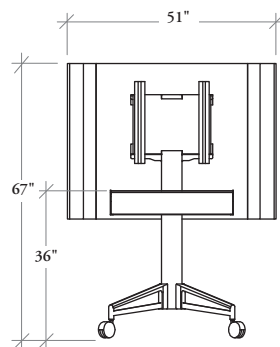

Bar

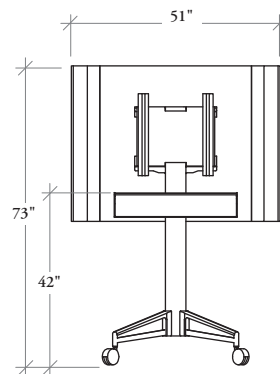

medium

Lounge

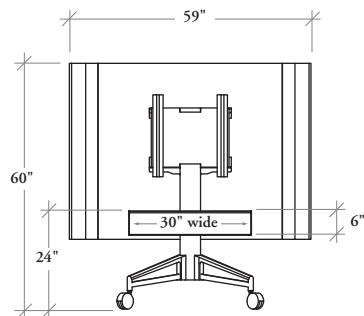

Task

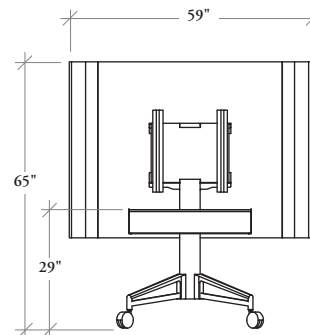

large

Lounge

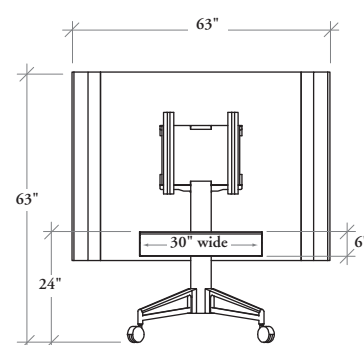

Task

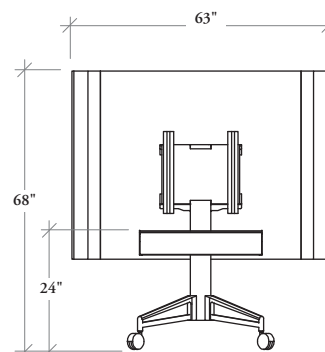

planning with the tek box

The following outlines the features of the Tek Box.

tek box

The Tek Box is installed on the front of the cart to house technology. It is available as:

- An empty box to allow user to install their own components
- An integrated box with four power receptacles and four Sensor Docks to hold CLUBconnect Sensors. If used with CLUBconnect Support, the switcher will be located inside of the Tek Box
- Tek Box dimensions are 30" wide x 6" high x 13" deep
- If being used with a worksurface, the Tek Box aligns with worksurface height at Lounge, Task, Counter and Bar heights

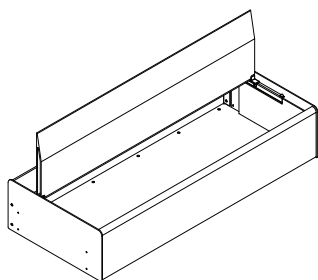

Tek Box without CLUBconnect Support

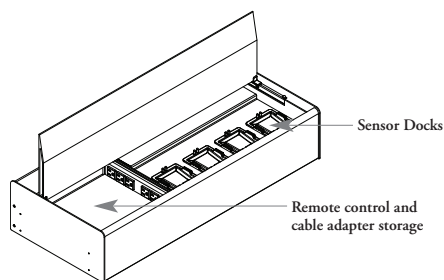

Tek Box with CLUBconnect Support

128

wire management for tek box with CLUBconnect support

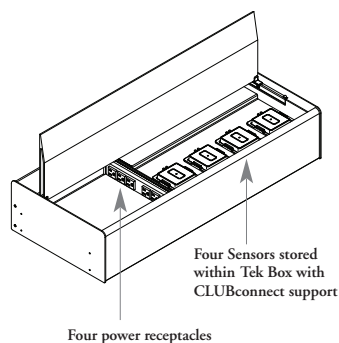
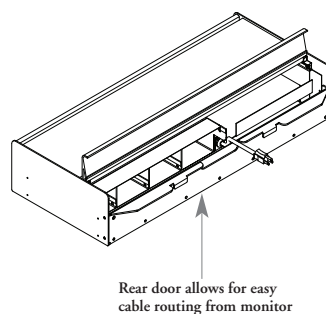
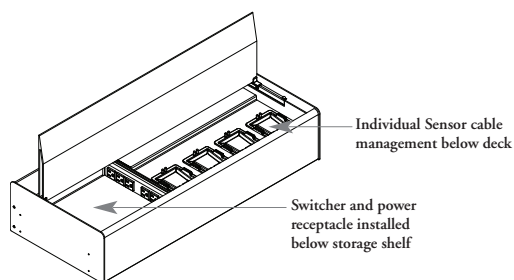

specifying the mobile cart

The following should be considered when specifying the Mobile Cart.

planning considerations

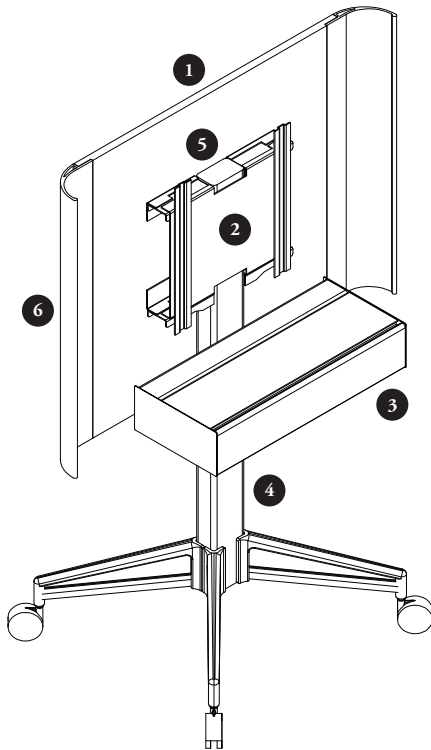

- 1 Determine what size of surround is required. It is recommended that a small surround be used with all CLUBtalk Tables. Medium or large surrounds are more suitable for lounge applications or applications where groups larger than four people will be collaborating and viewing the monitor.
- 2 The size of the surround will determine the monitor size that can be used.
- 3 Determine the required tech support - with or without a Tek Box or a Tek Box with or without CLUBconnect support.
- 4 Determine what height will best suit the application that the Mobile Cart will be used for; Lounge, Task, Counter or Bar heights.
- 5 Determine if a camera shelf is required. It can be added to the cart for video conferencing capabilities.
- 6 Identifiers can be added to the cart to help identify the Mobile Carts in an open plan and allocate them to specific areas on the floor plate.

tables basics

CLUBtalk Tables are available in various shapes and sizes and are intended to integrate with CLUBconnect (CUT).

CLUBtalk Tables

Each table includes an Access Door Module with Sensor Docks. The CLUBconnect Sensors (CUT) must be ordered separately.

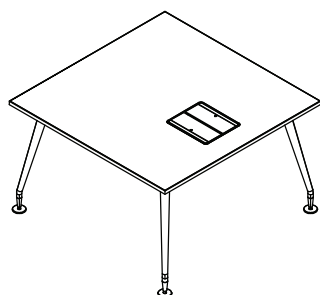

Square Table (CUS)

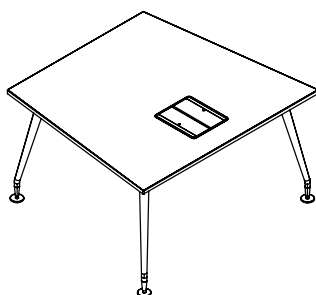

Trapezoid Table (CUZ)

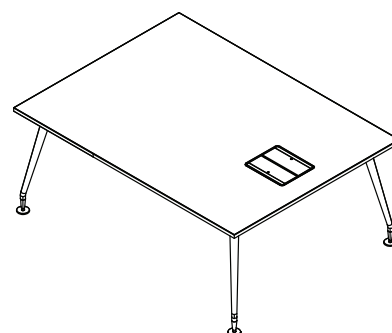

Rectangular Table (CUR)

Tables

The Worksurface includes stretch legs that can also be found on Teknion's Audience Boardroom and Meeting Tables

Access Door Module

Access Doors (with a cable opening) include a grommet and an underpan that houses four Sensors Docks and four convenience receptacle outlets

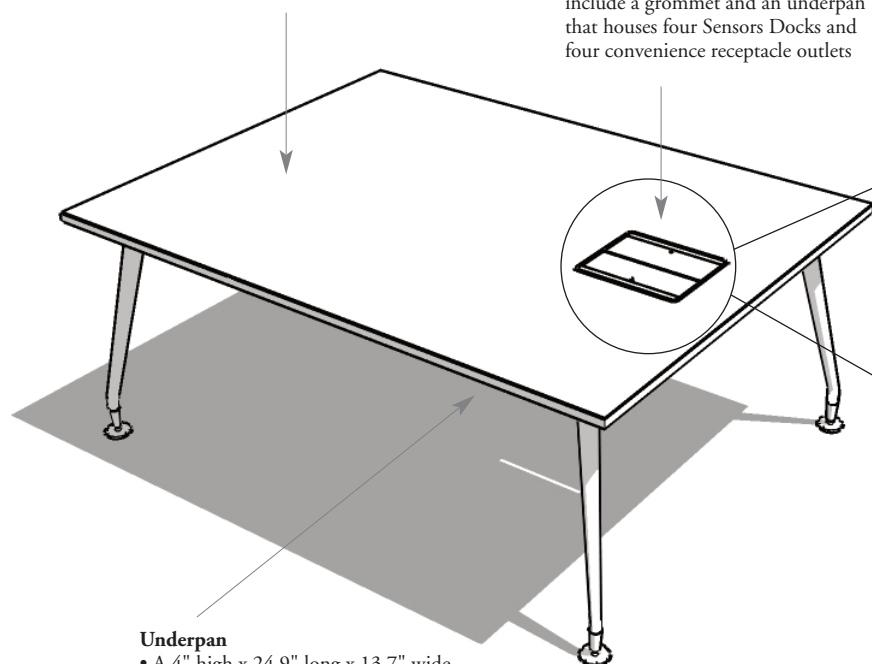

Underpan

- A 4" high x 24.9" long x 13.7" wide underpan located under the table conceals Sensor cables and the Switcher which is located adjacent to the Sensors
- Includes two blank data ports

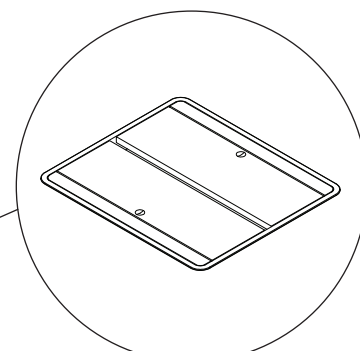

Closed Access Doors

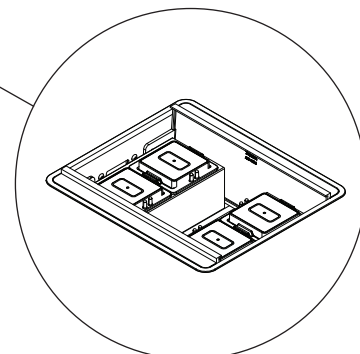

Access Doors open with Sensors and a power receptacle

planning with tables

The following should be considered when planning with CLUBtalk Tables.

When planning with CLUBtalk Tables, the grommet location on all of the tables is centered on the width side of the worksurface. The side of the table with the grommet needs to be aligned with the Tek Box (on the Mobile Cart) to allow the monitor to be powered and connected to the HDMI cable.

square table (CUS)

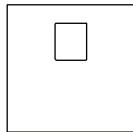

42" width

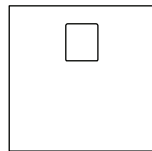

48" width

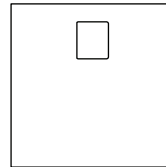

54" width

trapezoid table (CUZ)

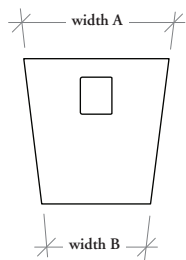

48" depth x 48" width A
(width B defaults to 36")

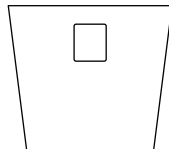

48" depth x 54" width A
(width B defaults to 42")

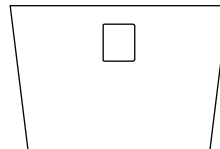

48" depth x 72" width A
(width B defaults to 60")

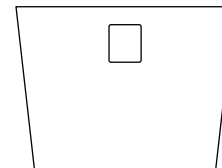

54" depth x 72" width A
(width B defaults to 60")

rectangular table (CUR)

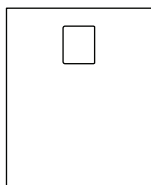

48" width x 60" depth

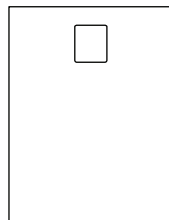

54" width x 72" depth

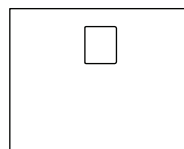

60" width x 48" depth

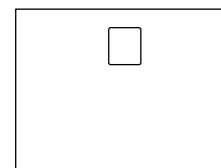

72" width x 54" depth

worksurface monitor mount component overview

The following outlines components and features of the Worksurface Monitor Mount.

The Worksurface Monitor Mount is used primarily in a wired setting in combination with Teknion's CLUBconnect technology.

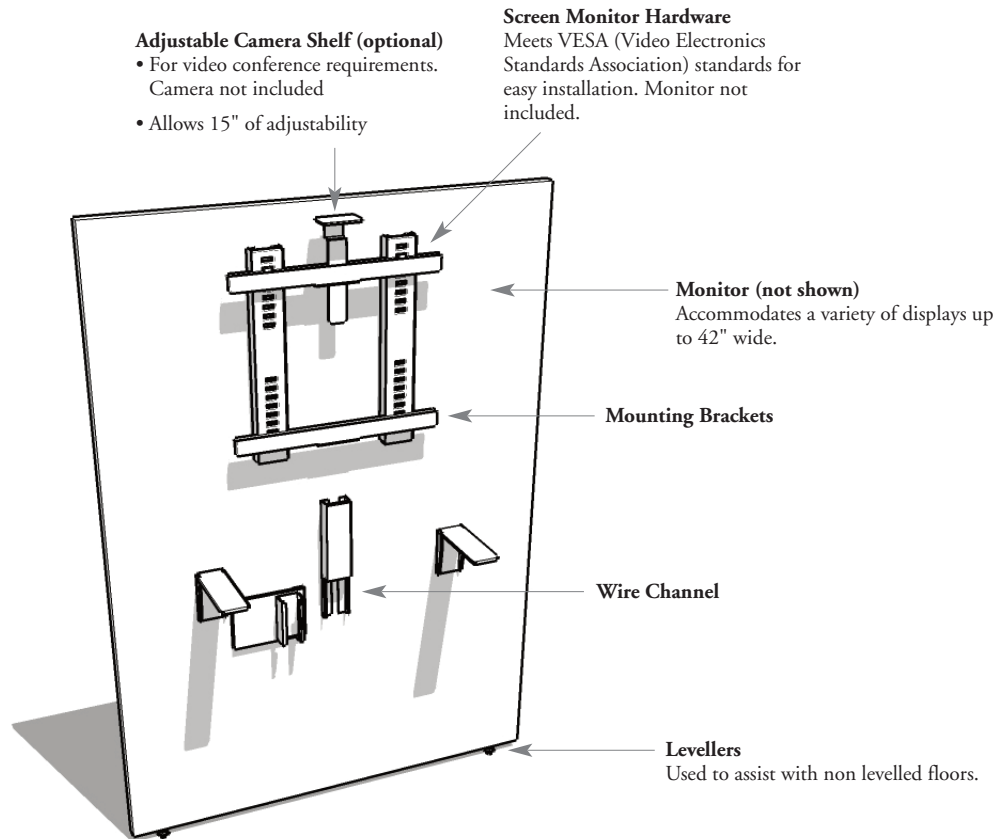

Screen Surface
Available 42" wide and 60" high and mounts to the end of a Meeting Table.

Sensor Shelf
Has four individual sensor openings.

Technology Enclosure
Used to house CLUBconnect technology and a 3 outlet Power Bar.

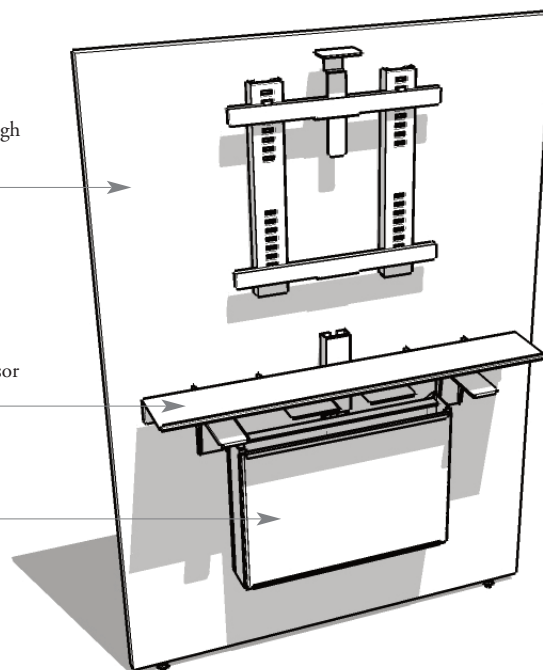

worksurface monitor mount basics

The Worksurface Monitor Mount mounts to the end of a meeting table and can be used in private meeting or open spaces. It is available with or without a Sensor Shelf.

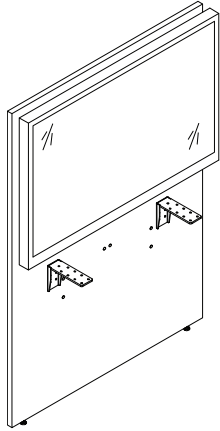

No Tek Shelf (N)

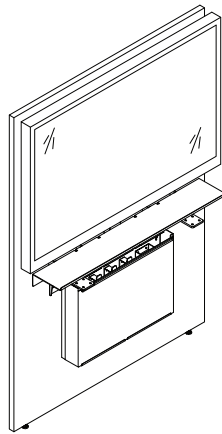

Tek Shelf with
CLUBconnect Support (Y)

Worksurface Monitor Mount (CUWM)

- Mounts to the end of a meeting table
- Provides two options:
 - Without Tek Shelf
 - With Tek Shelf
- Available only in 42" wide x 60" high
- Can accommodate a District Standing Storage Fascia (tackable fabric or whiteboard) on back side

planning with worksurface monitor mount

The following should be considered when planning with Worksurface Monitor Mounts.

worksurface monitor mount (CUWM)

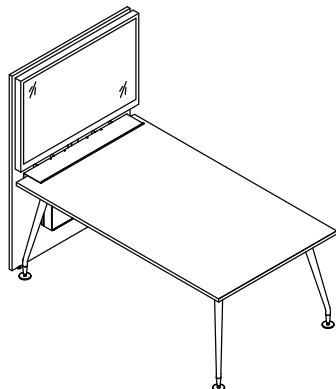

- The Monitor Mount requires a minimum of 27" width between the table legs to avoid interference with the screen brackets
- It is **not** suitable for 24" wide worksurfaces
- Can only be used on a 29" high table

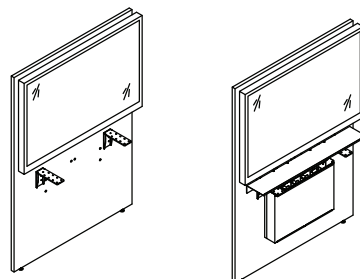

Maximum monitor size is 42" wide

134

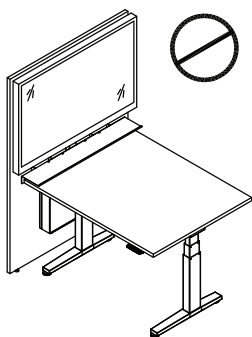

Must be mounted to fixed table. Cannot mount to any height adjustable surfaces or a table with casters.

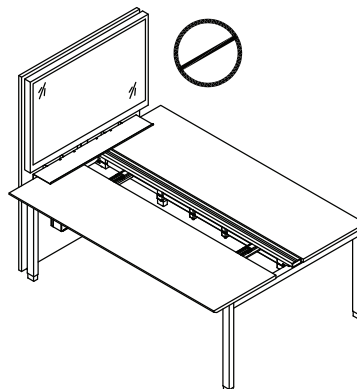

Cannot be mounted on a sliding worksurface.

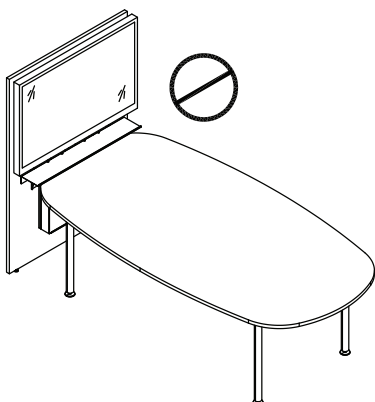

Cannot be mounted on a oval table

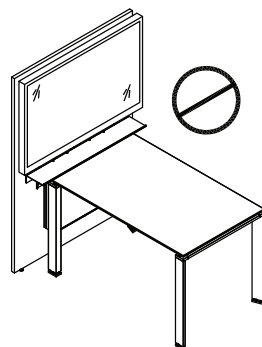

- **Cannot** be used as a table supporting structural member only as an add on piece
- **Cannot** be used where there is a spreader between table legs (example District Legs)

planning with worksurface monitor mount (continued)

power routing

Power routing can be done by three options:

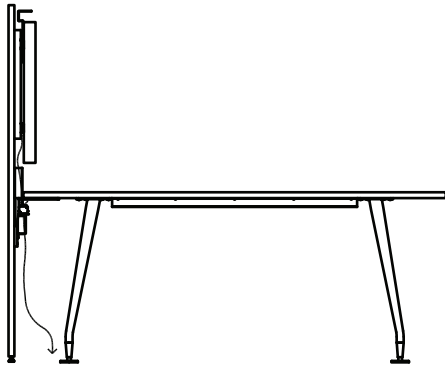

Power is routed down the front of the screen directly to the floor

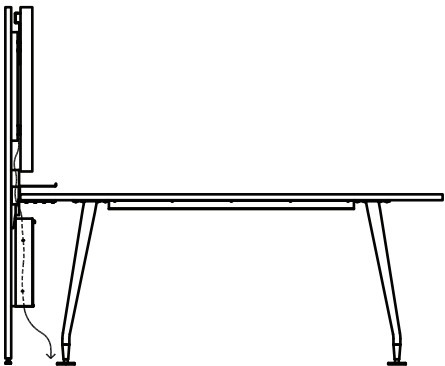

Power is routed through the Technology Enclosure directly to the floor

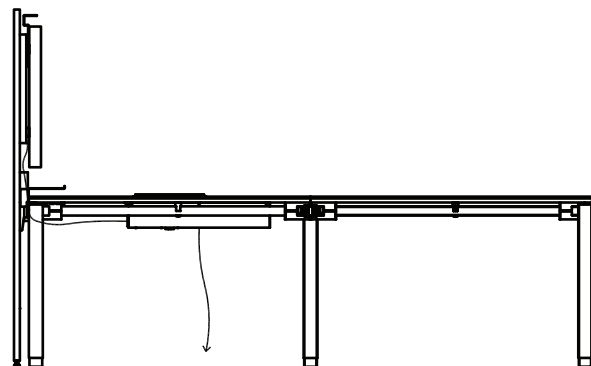

Power is routed down the front of the screen, along the bottom of the Interpret table, routes through CLUBtalk

13" modular table basics

The 13" Modular Table is an add-on component to an existing bench or square seat/ottoman. It can also be used as a half-width table between two modular seats.

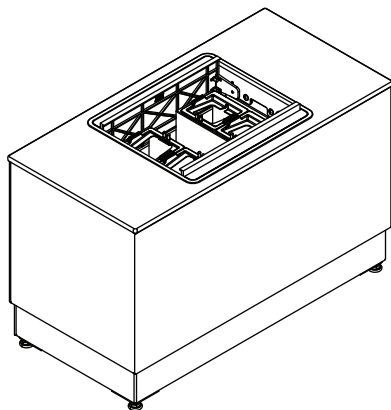

13" Modular Table (CUFM)

- Is used with the dna - Rectangular Freestanding Coffee Table (NDNU) or integrated within dna seating to provide CLUBtalk technology
- Available in 13" wide x 26" deep x 16" high

136

planning with 13" modular table

The 13" Modular Table is used with the dna Coffee Table to provide a wireless CLUBtalk application in a dna environment.

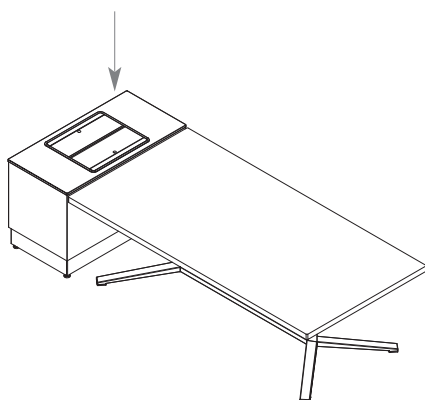

It can also be used between two dna benches.

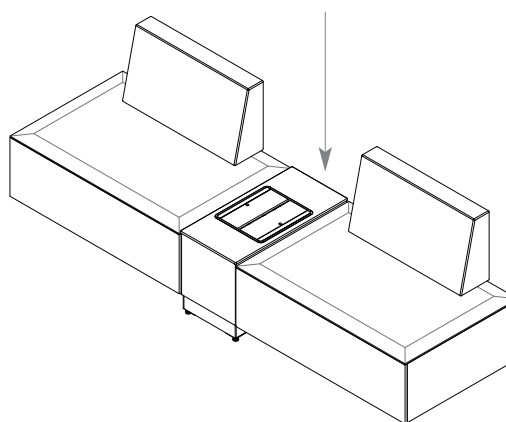

how CLUBconnect works

When CLUBconnect is used, multiple devices can be connected to allow for collaboration and data sharing.

The CLUBconnect's four Sensors allow users to share data in a collaborative space:

- All of the four Sensors send their signals (audio and/or video) to the Switcher when a source device is connected
- A Sensors' indicator is White when a signal is present but not active (on stand-by)
- When a Sensor is selected by the user, its indicator turns Green and the Sensor is active
- The Switcher routes the signal received from the active Sensor to a monitor
- The signal content is received by the monitor that is either wired with an HDMI cable or sent from a wireless HDMI transmitter to a wireless HDMI receiver mounted behind the monitor on a bracket
- The wireless transmitter is installed under the worksurface
- There are five ports available for sharing data, one for each Sensor and a fifth HDMI video source port which allows the user to connect a device without the use of a Sensor
- This additional port allows CLUBconnect to support video conferencing
- Included in the underpan is a three outlet power receptacle module and two blank data plates
- CLUBconnect provides a customizable screen saver, a welcome image or a video feature

CLUBtalk Mobile Cart (CUC) with wireless CLUBconnect technology in CLUBtalk table

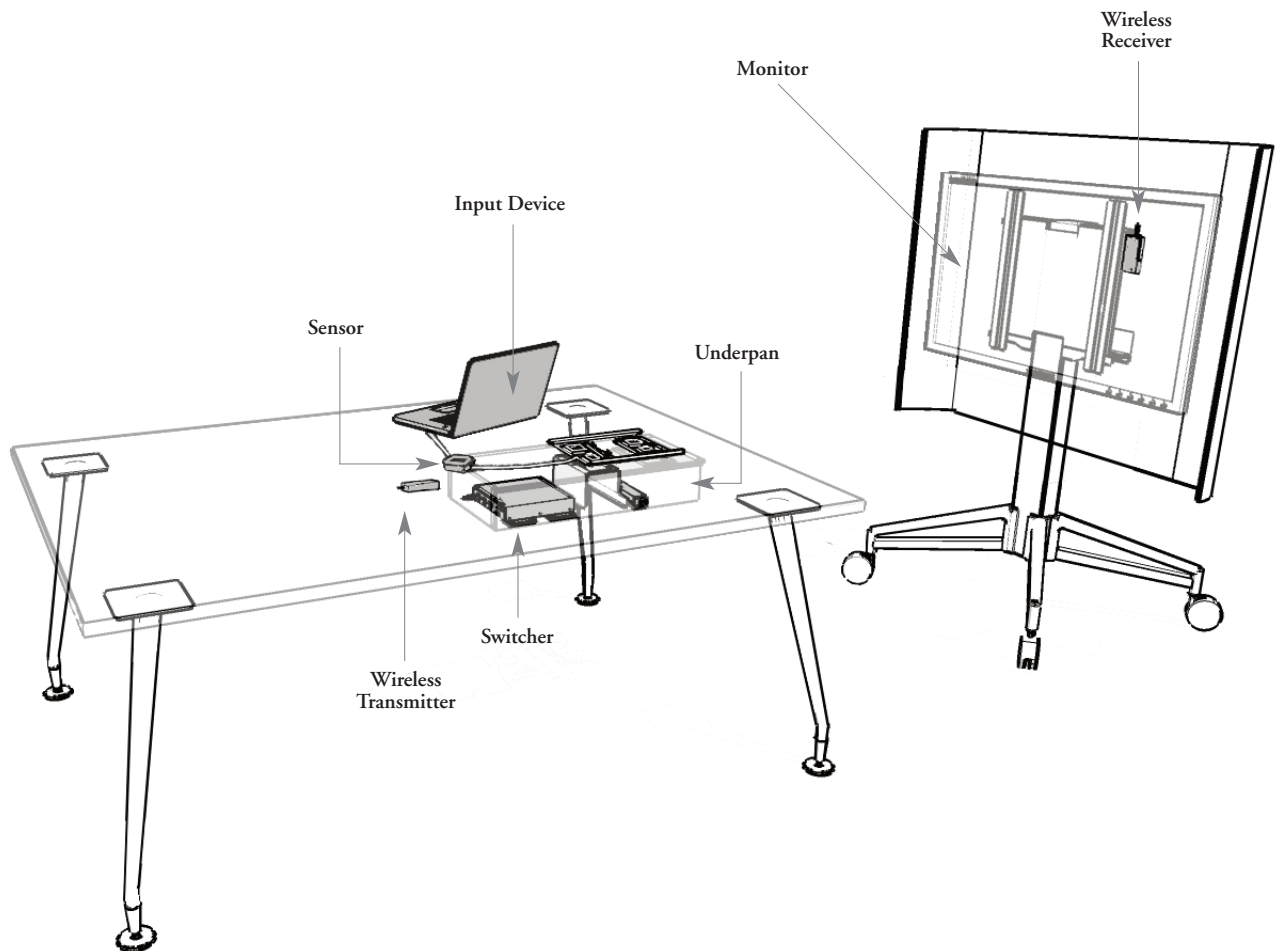

how CLUBconnect works (continued)

Worksurface Monitor Mount (CUWM) with wired CLUBconnect technology in Interpret table

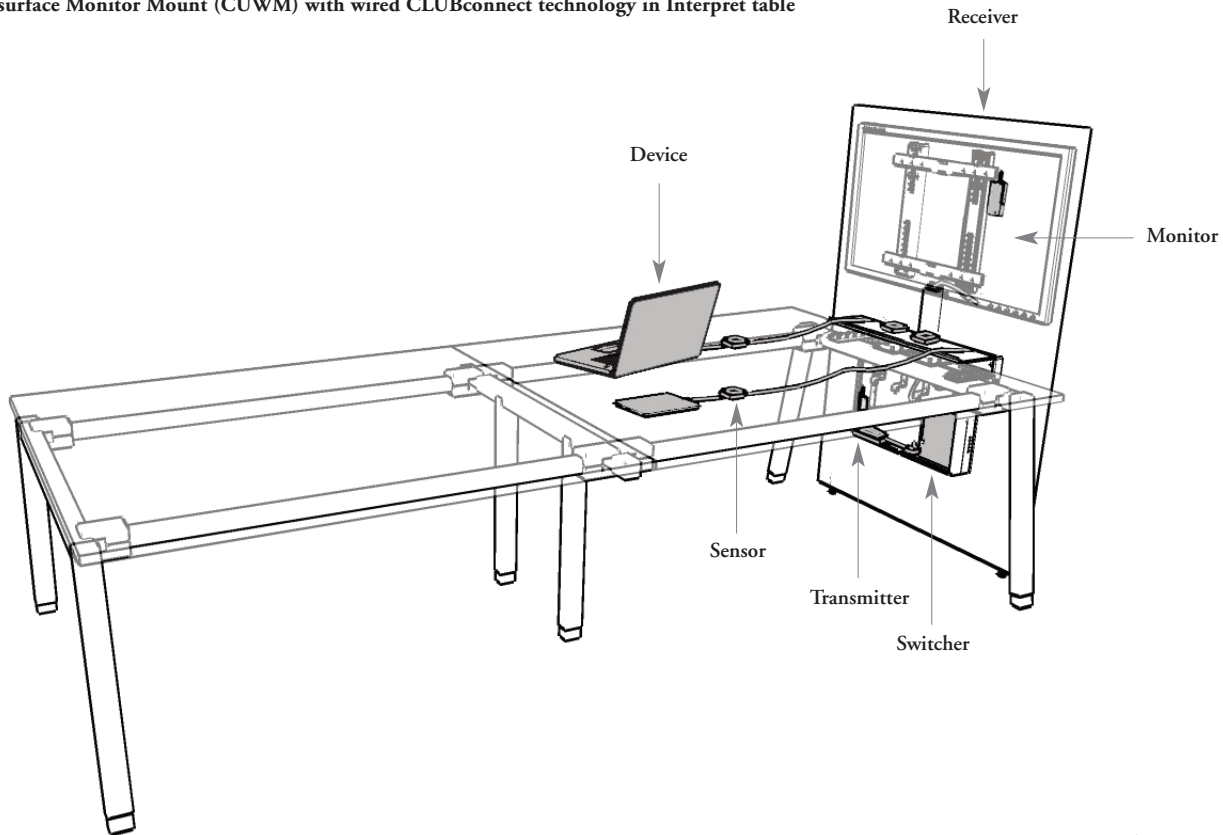

138

13" Modular Table (CUFM) with wireless CLUBtalk technology in dna Freestanding Rectangular Coffee Table with a Mobile Cart

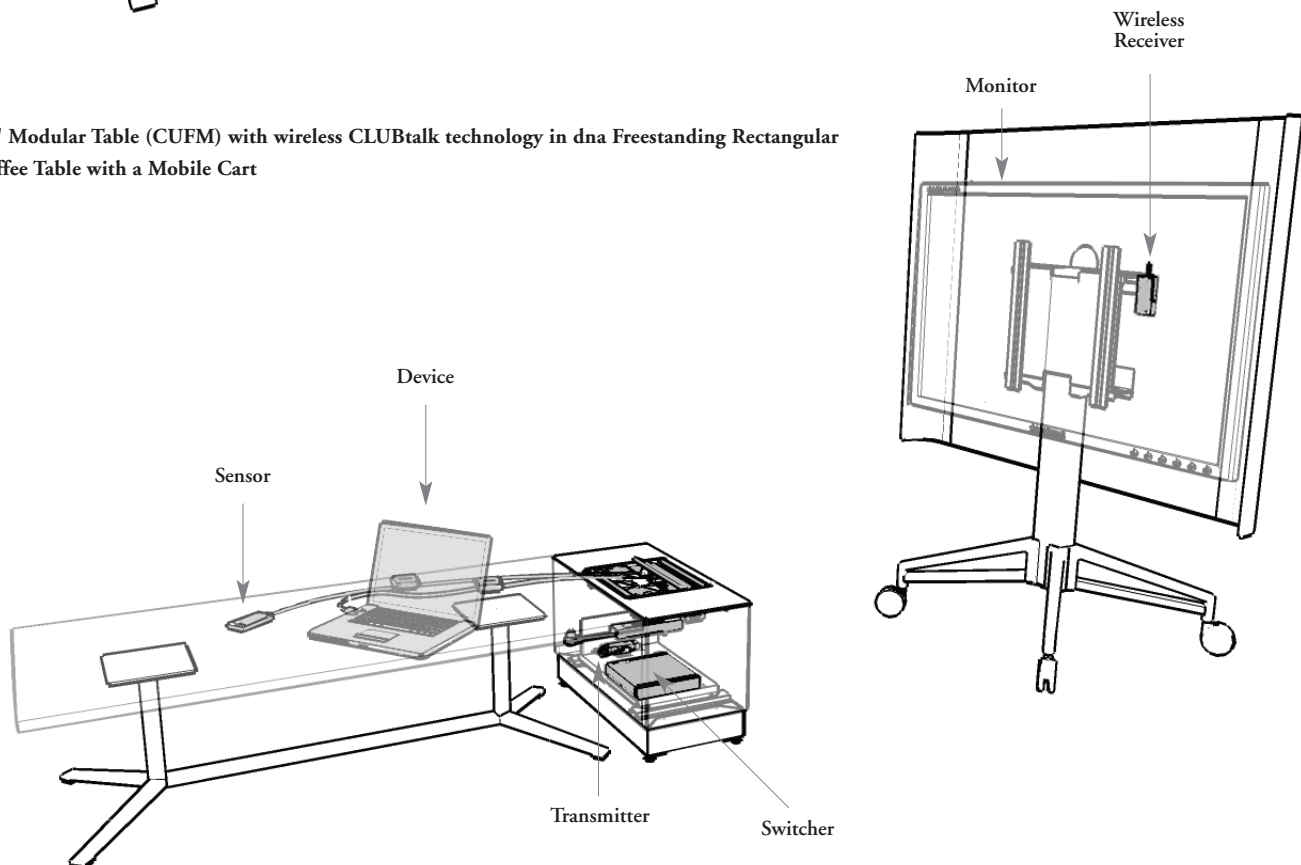

how CLUBconnect works (continued)

The diagram below illustrates how signals are routed from various devices to the monitor, in both wired and wireless applications.

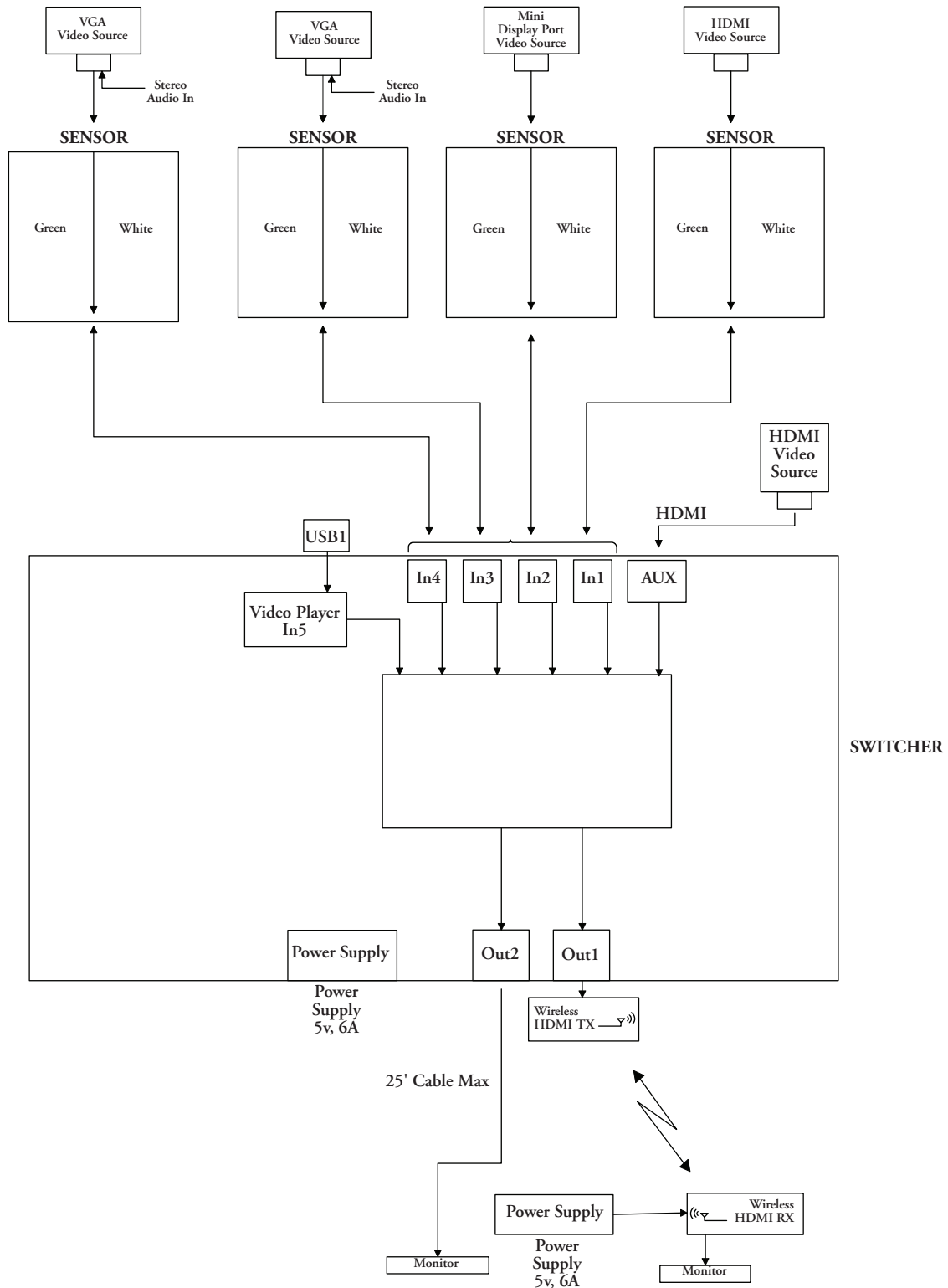

CLUBconnect basics

CLUBconnect is a stand-alone technology solution that can be integrated within the Tek Box or CLUBtalk table.

CLUBconnect (CUT)

- Includes 4 Sensors, a Switcher and Power Receptacle
- Optional Wireless Transmitter and Receiver

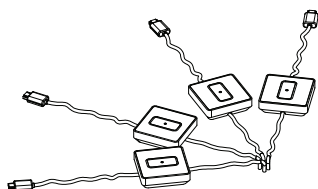

Sensors

- Each of the four Sensors can be specified in three different cable types, HDMI, VGA or Mini Display Port. These cables can then be connected to a mobile device such as a laptop, Smartphone or tablet (some devices may require additional adapters)
- VGA Sensors include an integrated audio jack on the Sensor
- To activate touch the center of the Sensor. The White light turns Green. This indicates it is active and sharing content. The Sensor light is White when the connected device is not being shared.
- Only one Sensor can be active at a time allowing content to be shared with a group one person at a time

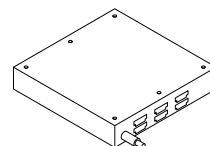

Switcher

- The Switcher is a device that routes signals received from any of the four Sensors to a display via a control signal from the Sensor
- A 6' HDMI cable is shipped with the Switcher to connect to the monitor

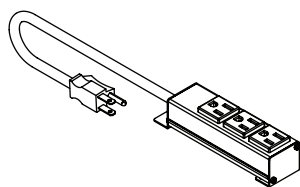
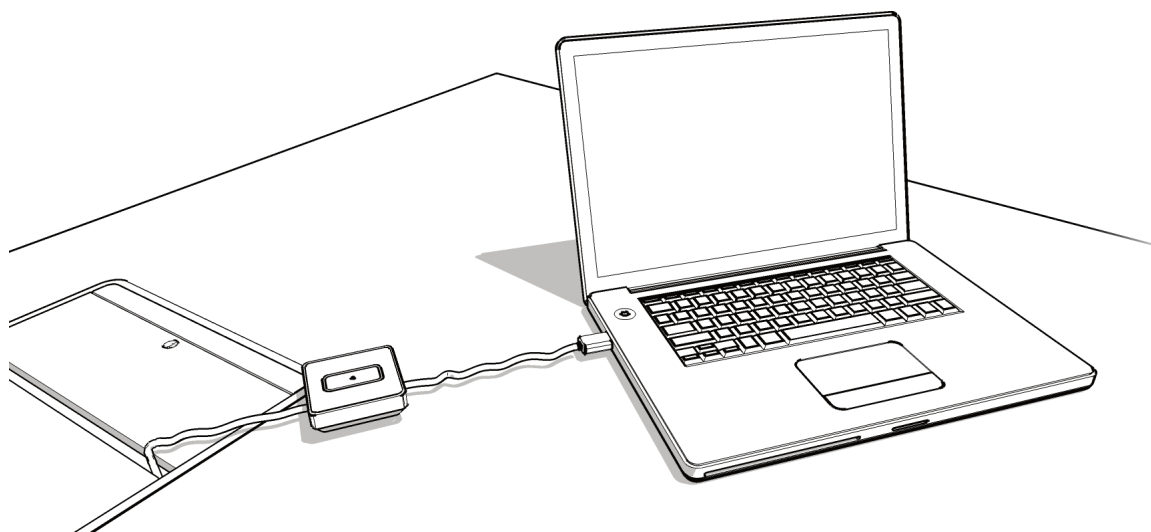

Power Receptacle

Three receptacle outlets are included with every CLUBconnect unit to power the technology.



CLUBconnect Wireless Transmitter & Receiver (optional)

- If the wireless option is chosen, a wireless transmitter and receiver will be included
- The transmitter cable is 3' and is used to connect the Switcher output to the wireless transmitter input
- The receiver cable 6' and is used to connect the receiver to the monitor

specifying CLUBconnect

The following should be considered when planning with the CLUBconnect.

planning considerations

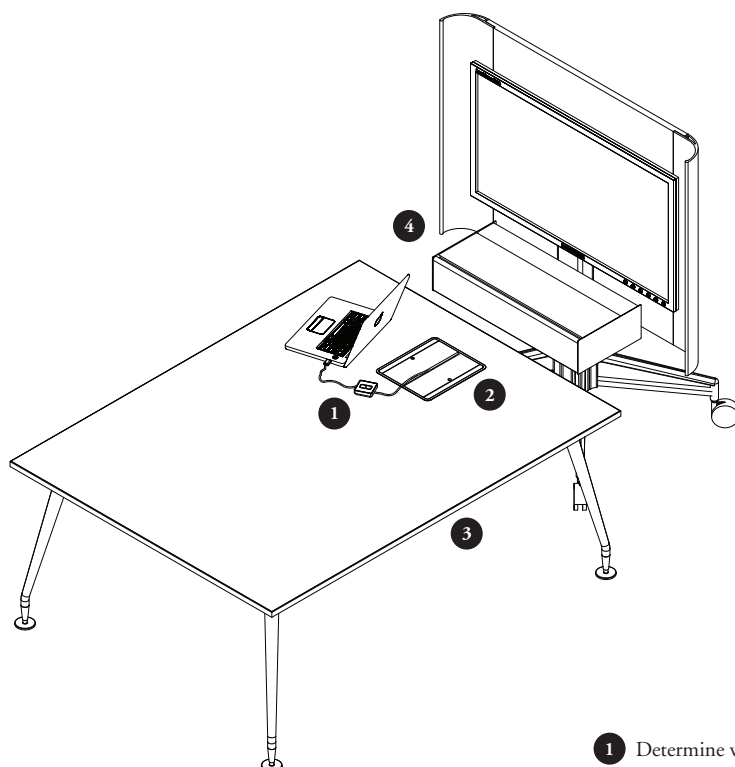

- 1 Determine which cable types are best suited for the application:
 - HDMI cables pass digital audio and video signals between compatible HDTVs, receivers, and other components
 - VGA cables combine video and audio signals and send them to the Switcher. An additional cable is needed for audio to connect from device to Sensor
 - Mini Display Port cables are used for digital audio and video which are used widely in notebook computers
- 2 Consider if it will be a wired or wireless application. If wireless is desired, a CLUBtalk table complete with an Access Door Module is one way to store and conceal the CLUBconnect technology. If the solution is to be wired, a Tek Box either empty or complete with CLUBconnect support, can also be used to house technology, accessories and equipment.
- 3 Consider worksurface length as each Sensor cable is 10' long. Depending on the application, either 10' from a Tek Box on the Mobile Cart or from the Access Door Module within a CLUBtalk Table. Ensure that each user is able to access the Sensor.
- 4 Determine what options are required on the Mobile Cart (Tek Box, Tek Box with CLUBconnect Support, Camera Shelf or Identifiers).

CLUBtalk finishes

The following outlines the finish options available for CLUBtalk.

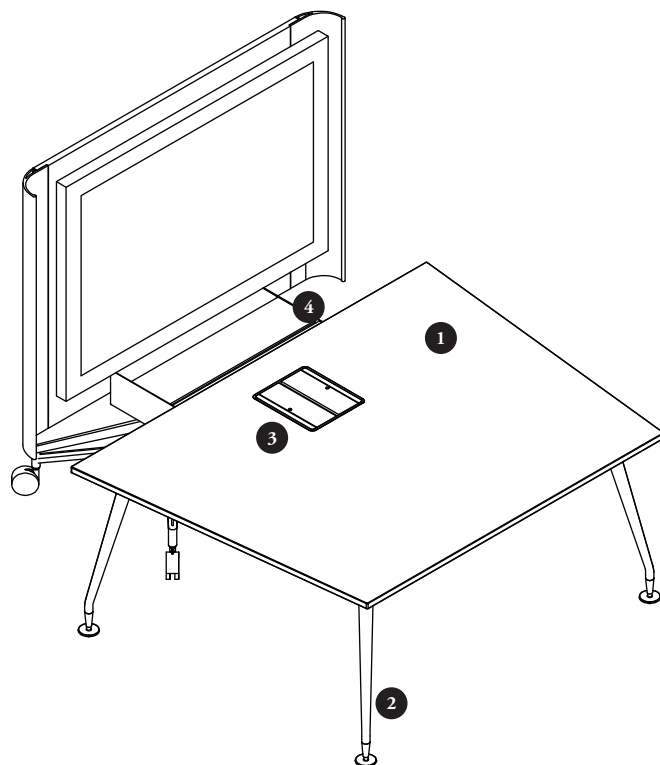

- 1 Table Tops are available in: Seamless, Foundation Laminate, Flintwood or Natural Venners.
Edges are available in: Bullnose Trim (2), Straight Trim (6), Flintwood Straight (7), Seamless Eased (E), Seamless Flat Edge (G), Seamless Full Knife Edge (X) Table
- 2 Legs: Painted Foundation, Painted Mica, Chrome
- 3 Access Door Module & Door Trim Finish: Foundation, Mica, Accent
- 4 Optional Tek Box: Painted platinum on the sides, Clear Anodized on the front & Lids

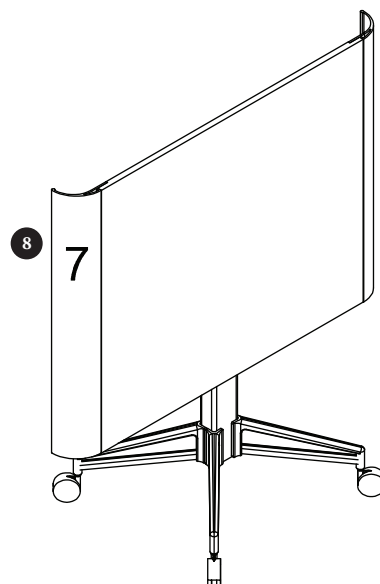
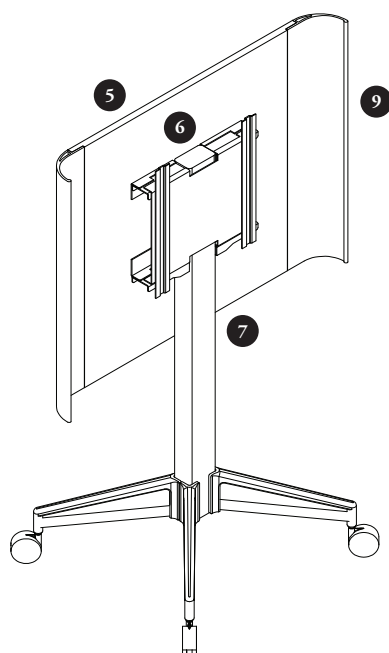

- 5 Surround on Mobile Cart: Seamless, Foundation Laminate, Flintwood, Natural Venner. Finish to match on both sides of surround
- 6 Optional Camera Shelf: Painted Platinum
- 7 Post on Mobile Cart: Painted Platinum
- 8 Optional Identifiers: Graphic Steel
- 9 Handles: Clear Anodized

CLUBtalk finishes (continued)

The following outlines the finish options available for Worksurface Monitor Mount and 13" Modular Table.

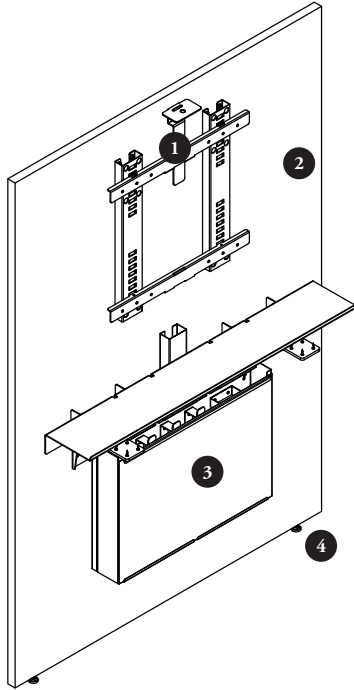

- 1 Mounting Brackets: Platinum only
- 2 Screen: Source Laminate, Seamless Color, Flintwood, Natural Veneer
- 3 Tek Shelf: Foundation, Mica
- 4 Levellers: Foundation, Mica

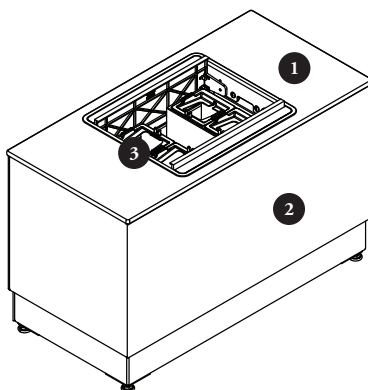





- 1 Top: Compact Laminate, Flintwood
- 2 Base: Foundation, Mica
- 3 Access Door: Foundation, Mica, Accent

grain direction

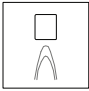
When planning with finishes it is important to note the grain direction for each finish on both the CLUBtalk Tables and the surround for the cart.

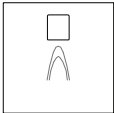
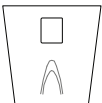
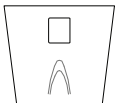
CLUBtalk tables

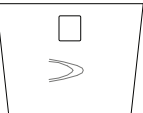
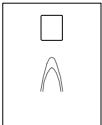
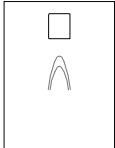
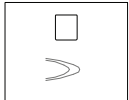
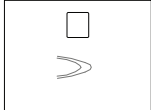
	Grain Direction			
Square Table (CUS)	 42" width	 48" width	 54" width	
Trapezoid Table (CUZ)	 48" depth x 48" width A (width B defaults to 36")	 48" depth x 54" width A (width B defaults to 42")	 48" depth x 72" width A (width B defaults to 60")	 54" depth x 72" width A (width B defaults to 60")
Rectangular Table (CUR)	 48" width x 60" depth	 54" width x 72" depth	 60" width x 48" depth	 72" width x 54" depth

I44

CLUBtalk mobile cart surrounds

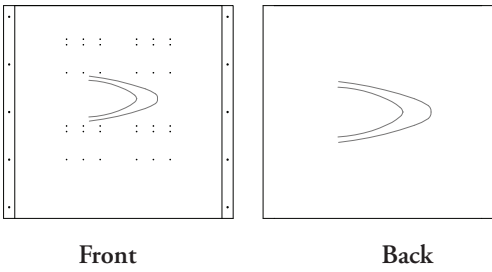

worksurface monitor mount

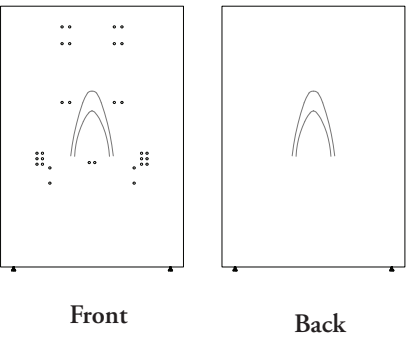

13" modular table

